

Kubota® L Series Sub Frame Installation Instructions



INTRODUCTION:

The Kage sub frame kit for the Kubota® L Series tractor is designed to fit the following Grand L40 Series models:

- L4240
- L4740
- L5040
- L5240
- L5740

The hydraulic functions of the Kage Sub Frame kit require the installation of the optional Kubota® 'loader' hydraulics including the Kubota optional 3rd hydraulic function (or auxiliary). If it is not apparent that these options are installed, please contact your Kubota® dealer.

GETTING STARTED

STEP 1:



Slide 'front bracket group' KL-506-1 into place under the front of the tractor. Lift up to align rear holes in front bracket with holes in the tractor frame. Loosely install ½" x 2.5" bolts.

STEP 2:



Hinge 'front bracket group' up and install front four 14mm x 45 bolts and lockwashers. Remove loosely installed rear ½" bolts.

STEP 3:



Slide the 'side curtain, driver' underneath the driver side of the tractor KL-405-Passenger. Lift front end of side curtain and align front hole with corresponding hole in the 'front bracket group'. Loosely install one 16mm x 45mm bolt and corresponding hardware (see parts break down).

STEP 4:



Lift rear of the 'side curtain, driver' into place and install and tighten all corresponding bolts (see parts break down for proper sizes).

STEP 5:



Slide the 'side curtain, passenger' KL-405-Passenger underneath the passenger side of the tractor. Loosely install one 16mm x 45mm bolt in front hole.

STEP 6:



Lift rear of 'side curtain passenger into place. Loosely install two 16mm x 55mm bolts and lockwashers in top two holes at rear. At the same time, re-install the tractor's 'engine compartment cover bracket', which holds the engine compartment cover in place, and 'quick-coupler bank bracket'.

STEP 7:



Install the 'L bracket group' L23-1 in the bottom two holes at the rear end of the 'side curtain passenger' using two 16mm x 55mm bolts and lockwashers.

STEP 8:



Install remaining bolts and hardware, and tighten (see parts breakdown for corresponding bolt sizes).

STEP 9:

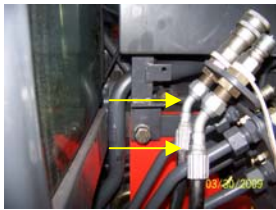

Remove the two flexible factory Kubota hydraulic lines from the back of the auxiliary couplers. Mount factory Kubota loader valve onto the 'L Bracket group' using two 16mm x 50mm (see parts break down for corresponding hardware)

STEP 10:



Install the supplied 'crossover relief valve' DRV-4HH-30-30 using two 5/16" x 3" bolts and hardware (see parts breakdown). Install two 1/2" MJ x 1/2" MP adapter's 06MJ-06MP into 'crossover relief valve. Re – connect the factory Kubota hydraulic lines to the 'A' and 'C' ports of the crossover.

STEP 11:



Connect two 'crossover line's 16-508 to the crossover, and then to the back of each auxiliary hydraulic coupler.

STEP 12:



Install 'hose hoop bracket' K456-1 using 1/2" x 1.75" bolts (see parts break down for corresponding hardware)

IMPORTANT:

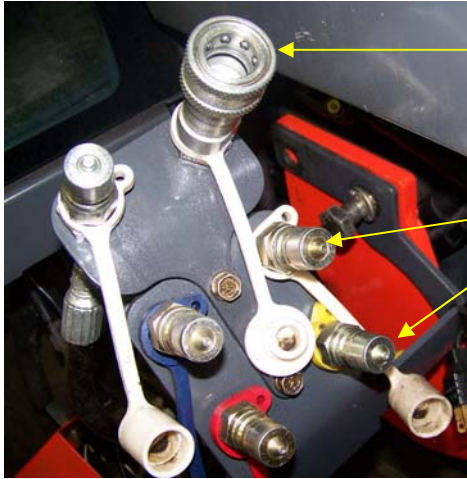

Top set - Controlled by button on the joystick. USE FOR PLOW ANGLE FUNCTION ONLY

Middle Set / Bottom Set – Controlled by motion of the joystick lever. Use for raise/lower, and for hydro lock (if applicable) functions.

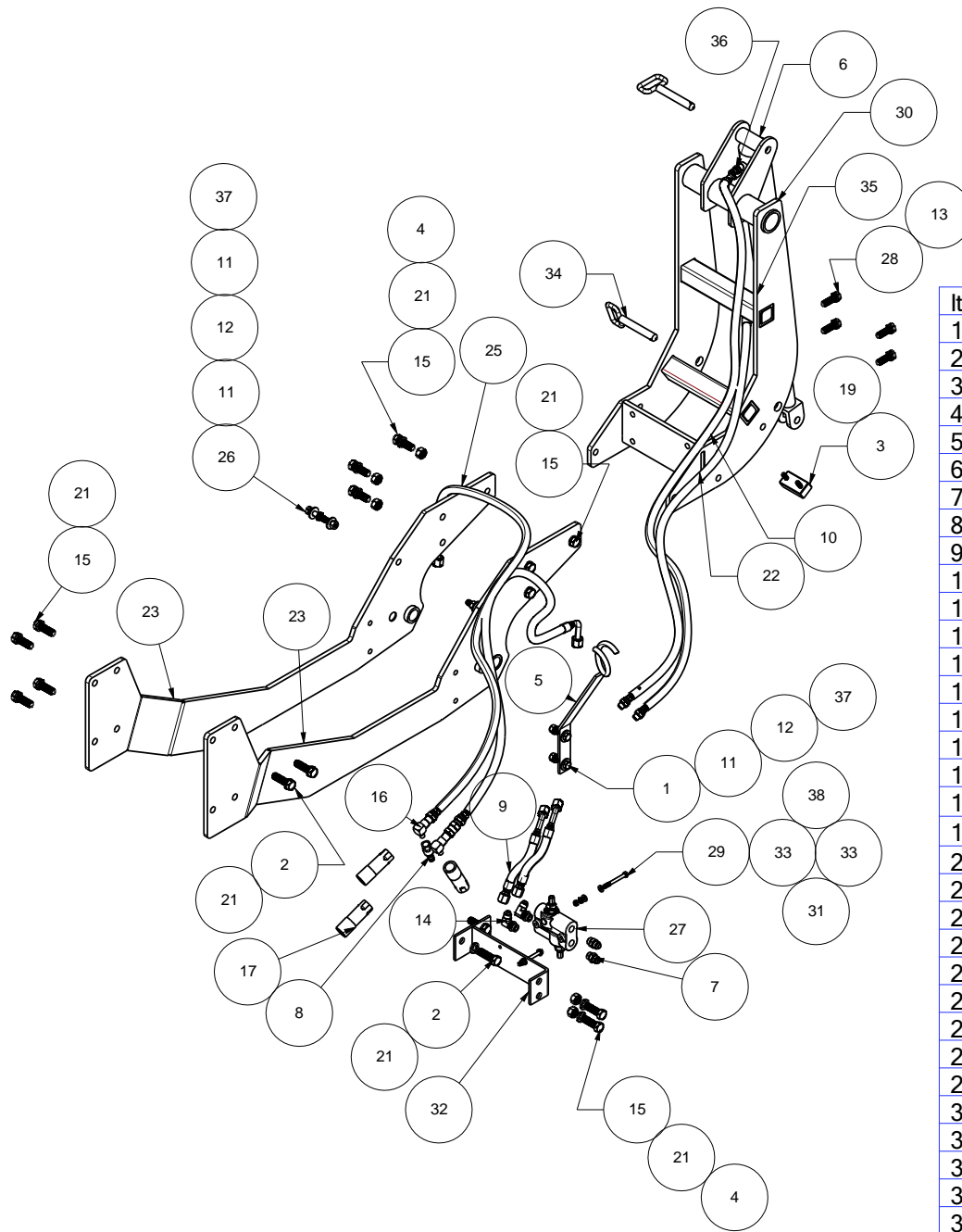

Item	Part Name	Part Number	Qty	Kit#
1	Hex Bolt GR5 1/2 - 13 x 1.75	92865A718	2	KUK2000
2	Hex Bolt Class8.8 MM16-1.5 x 55	91180A816	4	KUK2000
3	Bumper	9306K69	1	KUK2000
4	Hex Nut Class8 MM16-1.5	91415A265	8	KUK2000
5	Hose Hoop Bracket	K456-1	1	
6	Lift cylinder	PMC-5416	1	
7	JIC x ORB Straight	08MB-08MJ	2	
8	Hydro Coupler, Male	G94511-0606	1	
9	crossover line	HY-701-ORB	2	
10	Line, Tractor to Lift cylinder top	71-508	1	
11	Flat Waher GR5 1/2	ROC-8071-033	6	KUK2000
12	Split Lockwasher, 1/2	ROC-8076-033	4	KUK2000
13	Lock Washer MM14	91169A220	4	KUK2000
14	JIC x ORB 90 Elbow	08MB-08MJ90	2	
15	Hex Bolt Class 8.8 MM16-1.5 x 50	91180A876	12	KUK2000
16	90 Elbow	6mp_8fpX90	2	
17	Hydro Coupler, Female	G94521-0606	3	
18	Line, Tractor to Angle cylinder, Pass	58-180	1	
19	Hex Bolt GR5 5/16-18 x 1.5	92865A587	2	KUK2000
20	Restrictor	1404R-08-08 .062	1	
21	Lock Washer MM16	91169A240	16	KUK2000
22	Line, Tractor to Lift Cylinder Bottom	57-505	1	
23	Side Curtain	KL-405-{Side}	2	
25	Line, Tractor to angle cylinder, Drive	87-508	1	
26	Hex Bolt GR5 1/2-13 x 2.5	91247A722	2	KUK2000
27	Crossover Relief Valve	DRV-5HH-30-30	1	
28	Hex Bolt Class10.9 MM14-1.5 x 45	91310A768	4	KUK2000
29	Hex Bolt, 5/16 - 18 * 3	91247A595	2	KUK2000
30	FRONT BRACKET GROUP	KL-506-1	1	
31	Lockwasher, 5/16	ROC-8076-030	2	KUK2000
32	L Bracket Group	L23-1	1	
33	Flat Washer, 5/16	ROC-8071-030	4	KUK2000
34	Hitch Pin	90146A215	2	KUK2000
35	Pipe x JIC Adapter	06MJ-06MP	1	
36	PipexJIC Long Nipple	2404-06-06-L	1	
37	Hex Nut GR5 1/2-13	95462A033	4	KUK2000
38	Hex Nut, 5/16 - 18	90473A030	2	KUK2000